

3610

RESIDENTIAL STEEL COLLECTION



Traditional Raised Panel Insulated Sandwich Residential Garage Door

2" thick insulated sandwich panel constructed of top quality materials, highly detailed raised panel embossment, deep woodgrain texture and two coat prefinished paint system all combine to enhance the beauty of your home.

MODELS

3610 Insulated - R value: 10.25

3650 Insulated Flush Panel

**GARAGE
DOOR**
SUPPLIERS INC.

Romans 12:6-7

"...if your gift is serving others, serve them well."

3610 RESIDENTIAL STEEL COLLECTION

Features:

- Sandwich type construction with CFC free expanded polystyrene insulation pressure bonded between two sheets of 26 gauge hot dipped galvanized steel with a 10.25 R value.
- 1.0 mil paint system includes .25 mil rust inhibiting primer and .75 mil exterior bp coat that resists fading and chalking while providing consistent color from panel to panel.
- 20 gauge hot dipped galvanized steel hinge plates run the full height of each section at all hinge locations to facilitate the attachment of hinges, handles, struts and step plates.
- Rigid aluminum retainer provides added strength while securing replaceable U-shaped bottom weatherstrip.
- Sections include tongue and groove meeting rails for superior strength and better sealing against wind, rain and snow.

#306 Sherwood



#305 Williamsburg



#591 Cascade



#393 Cathedral



#397 Stockton



#597 Stockbridge



#320 Waterton



Not all glazing options may be available from all distributors.

Cut-away view:

- Tongue and groove meeting rails.
- CFC free expanded polystyrene insulation.
- 20 gauge hot dipped galvanized steel hinge plates.
- Rigid aluminum retainer

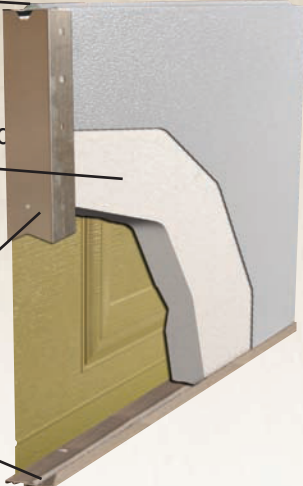

Sizes Available:

DOOR WIDTH	PANELS WIDE	HEIGHTS AVAILABLE:
8', 9'	4	6'6", 6'9", 7'0", 7'6", 7'9", 8'0"
10'	5	
12'	6	
14', 15'	7	
16', 17', 18'	8	
20'	9	

Colors Available:



Brochure color may vary from actual product.

Authorized Dealer:



Romans 12:6-7

"...if your gift is serving others, serve them well."